

文件编号

## PD60-7025 Series

### Features

- Low Voltage Operation
- Low Capacitance and High Speed with

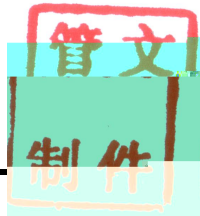

### Mechanical Dimension and Pin Assignment:

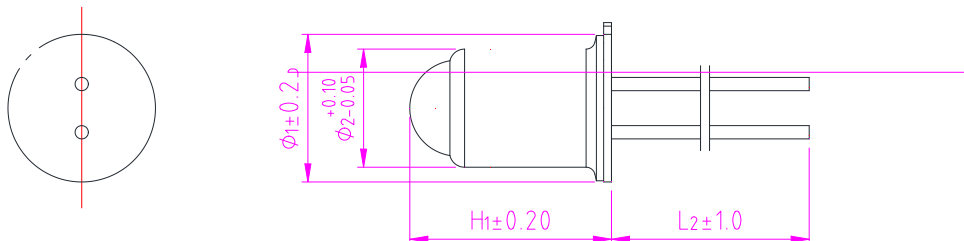

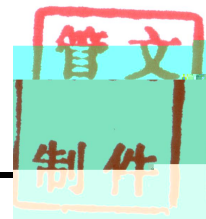

## Standard Product List:

Product name	$l_1$ (mm)	$l_2$ (mm)	$H_1$ (mm)	$L_1$ (mm)	$L_2$ (mm)	Received light form
PD60-TO25-BL(High)-2pin-A	2.5	1.96	3.35	12.7	12.7	Divergent light
PD60-TO25-BL(High)-2pin-B	2.5	1.96	3.35	14.0	14.0	
PD60-TO25-BL(High)-2pin-C	2.5	1.96	3.35	15.52	17.52	
PD60-TO25-BL(Short)-2pin-A	2.5	1.96	2.92	12.7	12.7	Parallel light
PD60-TO25-BL(Short)-2pin-B	2.5	1.96	2.92	14.0	14.0	
PD60-TO25-BL(Short)-2pin-C	2.5	1.96	2.92	15.52	17.52	

- Standard and custom designs to suit your systems.

## Order Information:

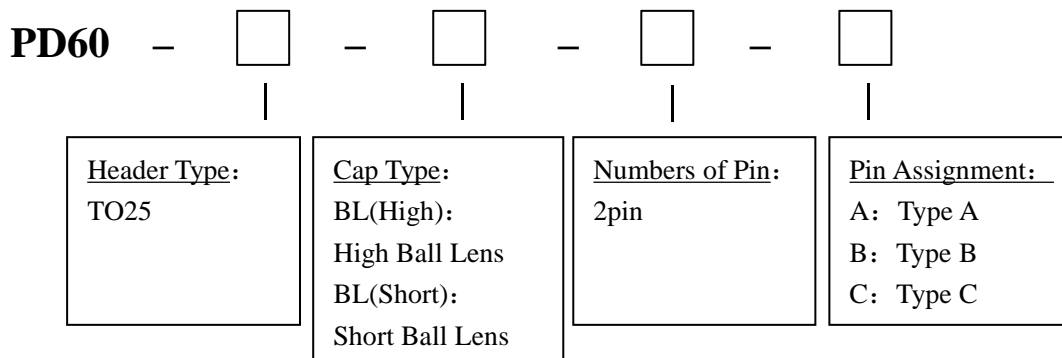

### Statement:

SAN-U owns the authority for final explanation of all information contained in this document, which is subject to change without notice. All the information was obtained in particular environments; and SAN-U will not be responsible for the performance of the customers' actual operating environments. All information contained is only for the users' reference and shall not be considered as warranted characteristics. SAN-U will not be liable for damages arising directly or indirectly which from any use of the information contained in this document.

### Contact Information:

Address: N501-505 Weiye Bldg., Xiamen Pioneering Park For Overseas Chinese Scholars, Xiamen, Fujian, China

Tel: +86-592-3898601, 3898608, 5318000

Fax: +86-592-5703588

Email: sales@san-u.com

<http://www.san-u.com>